



New York City Transit



Integrating Pollution Prevention through Environmental Management Systems

Greening the Government: A
Sustainability Conference for
Government Officials

*Ajay Singh, Chief
Sustainability and Environmental Management*

ISO 14001

MTA New York City Transit
Capital Program Management

New York City Transit's Department of Capital Program Management (CPM)



➤ Rebuild and improve the NYC Transit system by planning, designing, and building excellent Capital Projects.

➤ Registered ISO 14001 Environmental Management Systems, March 1999

➤ Part of USEPA
9 Municipalities Program

ISO 14001

MTA New York City Transit

SIX PILLARS OF CPM'S MISSION



ISO 14001

MTA New York City Transit

Why Implement EMS ?



- Regulations (City, State, Federal)
- Complements Environmental Review Process (EA/EIS)
- Our responsibility as a Public Agency
- Increase Productivity
- Decrease liabilities and litigation
- Leadership, Excellence

"To create a legacy for future generations by constructing long lasting, energy efficient, environmentally sustainable buildings, facilities and projects."



ISO 14001

MTA New York City Transit

New York State Governor Pataki's Executive Order 111:



"Green and Clean State Buildings and Vehicles"

- Directs State Agencies to be more energy efficient and environmentally aware
- Increase power use from renewable energy sources to 20% by 2010
- Procurement of Clean Fuel light-duty Vehicles 50% by 2005, 100% by 2010

ISO 14001



EMS Initiatives at NYC Transit



- Design for Environment (DfE)
- Construction for Environment (CfE)
- Energy Efficiency & Conservation Committee (EE&C), MTA-wide

ISO 14001



Design for Environment (DfE)



- CPM Sustainable Design Guidelines® established for ALL Capital Improvement Projects
- Major Projects include:
 - Stillwell Ave Terminal Station
 - Roosevelt Ave Inter-modal Station Rehabilitation
 - Corona Maintenance Facility
 - Central Maintenance Facility II
 - Lower Manhattan Transportation Improvement Projects

ISO 14001



CPM Sustainable Design/ DfE Guidelines®



- Energy Efficiency
- Enhanced Indoor Environmental Quality (IEQ)
- Conserving Materials and Resources
- Operations & Maintenance
- Water Conservation and Site Management
- Construction Site Management (CfE)



ISO 14001



Stillwell Ave Terminal Station



• Photovoltaic Canopy 150KW

• Natural Ventilation

• Natural Lighting

ISO 14001

MTA New York City Transit

Roosevelt Ave inter-modal Station Rehabilitation

• Photovoltaic Canopy 60KW

• Natural Lighting



ISO 14001

MTA New York City Transit

Corona Maintenance Shop

• Photovoltaic Panels 200KW

• 30% more energy efficient than code

• Uses rainwater & recycled water to wash trains

• Pre-treats effluent discharge to City water system

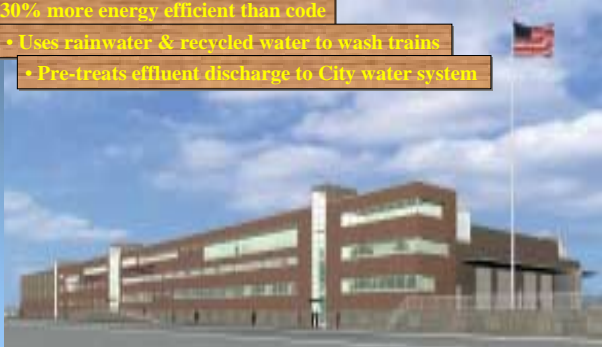

ISO 14001

MTA New York City Transit

Central Maintenance Facility & Grand Avenue Bus Depot

• Photovoltaic Panels roof mounted 100KW

• Uses rainwater & recycled water to wash Buses

• Paint booths equipped with VOC Abatement Systems



ISO 14001

MTA New York City Transit

Construction for Environment (CfE)



Minimize Impact to

- Air Quality
- Noise and Vibration
- Access & Circulation
- Cultural Resources
- Business/Economic Resources

ISO 14001



Construction for Environment (CfE)



Site Management

- Reduce impact to Air Quality
 - Ultra-low sulfur diesel fuel in off-road construction equipment
 - Retrofit technologies such as Particulate Filter / Diesel Oxidation Catalyst
 - Limit idling time

ISO 14001



Roosevelt Ave Diesel Exhaust Emissions Pollution Reduction



Technical Specifications

- Ultra Low Sulfur Diesel Fuel #1 Red (15ppm)
- Test Protocol ISO 8178C1
- Engine tested – Deutz Diesel
- Make: CEP Dieselytic
- Model: 7SX-P (compressor) & 14SX-F (backhoes) Diesel Exhaust Gas Purifier
- Manufacturer: Catalytic Exhaust Products Ltd., Canada
- Equipment:
 - Compressor, I.R. 1300, rated at 350HP
 - Backhoes, CAT M 315, rated at 114 HP
- Installation Date: February 2003
- Fuel Quantity used to date:
 - February 2003: 144 gal
 - March 2003: 1,172 gal

ISO 14001



Air Quality



Improving Air Quality – reducing diesel exhaust pollution



Diesel oxidation catalyst

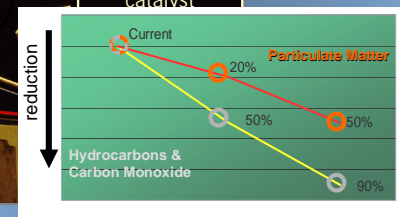

ISO 14001



Construction for Environment (CfE)



Site Management

- “De-Construct” instead of Demolition
- Implement a Waste Management Plan
 - Segregate materials (ex: Concrete, steel, wood)
 - Recycle minimum of 50% by weight
- Already done at Roosevelt Ave, Queens and Stillwell Ave, Brooklyn

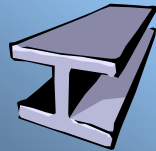

ISO 14001

MTA New York City Transit

Roosevelt Ave Waste Management Plan



86% Deconstruction Waste Recycled

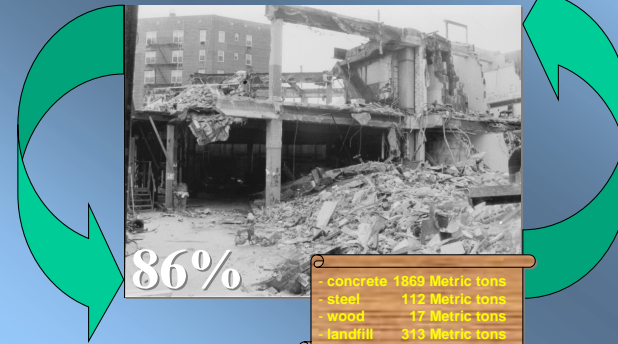

ISO 14001

MTA New York City Transit

Stillwell Ave Waste Management Plan

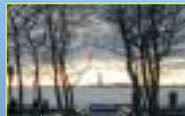

85% Deconstruction Waste Recycled



ISO 14001

MTA New York City Transit

Lower Manhattan Transportation Improvements



- Key to the Future of Downtown
 - South Ferry Terminal Station
 - Fulton Street Transit Center
- Projects include explicit Environmental Performance Commitments (EPC's) to minimize or avoid adverse impacts

ISO 14001

MTA New York City Transit

South Ferry Terminal Station



ISO 14001

MTA New York City Transit

Fulton Street Transit Center



ISO 14001

MTA New York City Transit

Fulton Street Transit Center

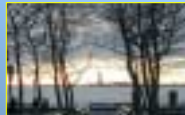

ISO 14001

MTA New York City Transit

Energy Efficiency & Conservation Committee (EE&C)



New York City Transit does Energy Conservation... in a Powerful Way

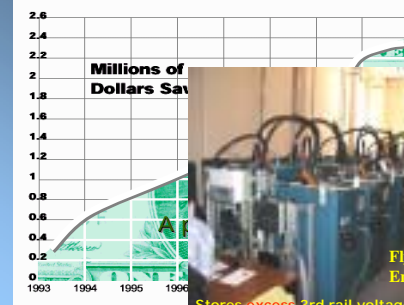

Stores excess 3rd rail voltage for later use

- Energy-Saver lighting controller
- Wind Turbines
- Flywheel Technology

ISO 14001

MTA New York City Transit

Eco-Procurement

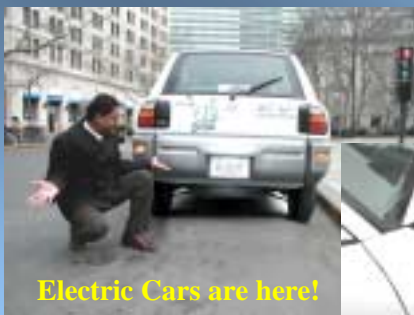

ISO 14001



Reaching out to others...



- City of New Delhi sought ISO 14001 certification for a new \$6 billion urban railway system.
- Delhi Metro was able to achieve ISO 14001 certification in 10 months with help from CPM

ISO 14001



A look to the Future...



Goals

- Continue to find new ways to be Resource Efficient (energy, water, materials)
- Expand ISO 14001 EMS to other Transportation Agencies
- Continue to expand Eco-Procurement and partner with Suppliers, Universities and other Agencies
- Continual Improvement...



ISO 14001



Contact Information:



New York City Transit
Capital Program Management

Division of Sustainability and Environmental Management

Ajay Singh, Chief
(646)252-4398
Ajsingh@nycct.com

ISO 14001

